

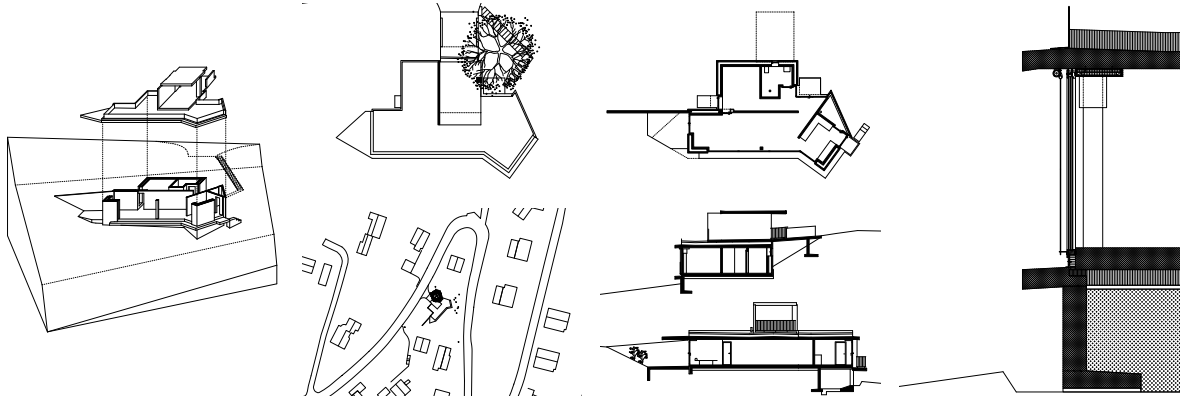

The private house in Thusis is a 24 meter long building with no dividing doors. The structure consists of a column, two walls and four building corners in light grey concrete, which together form a unit. The two walls run parallel to the trapezoidal plot and, together with the column, support the roof. They form a central, triangular entrance space and arrange the ground floor; they connect it to one room and divide the floor plan into different rooms: the living room, the kitchen and the private area. With floor-to-ceiling windows these spaces are almost infinitely connected to the landscape.



**PRIVATE HOUSE THUSIS
SWITZERLAND**